

RSB-11 SOUNDBAR FIRMWARE UPDATE INSTRUCTIONS **Klipsch** REFERENCE

These instructions apply to RSB-11 Soundbars with the Serial Numbers **1063117164500000** and below

1

Copy the "rsb11.hex" file and the "csr11b.ybin" file to an empty USB flash drive.

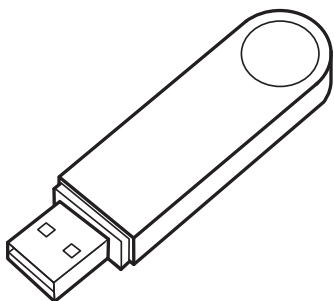

2

Unplug the power cord from the Soundbar.

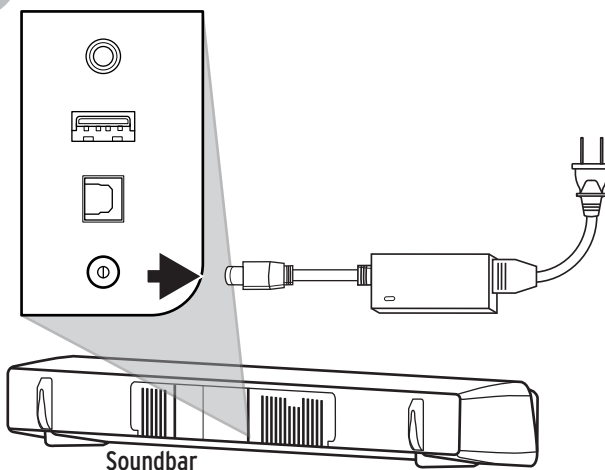

3

Insert the USB drive into the USB port on the rear of the Soundbar.

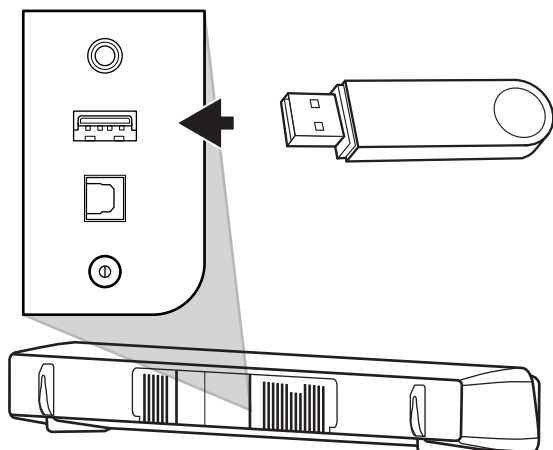

4

Press and hold the Vol+ key on the Soundbar, then plug in the power cord (while still holding the Vol+ key).

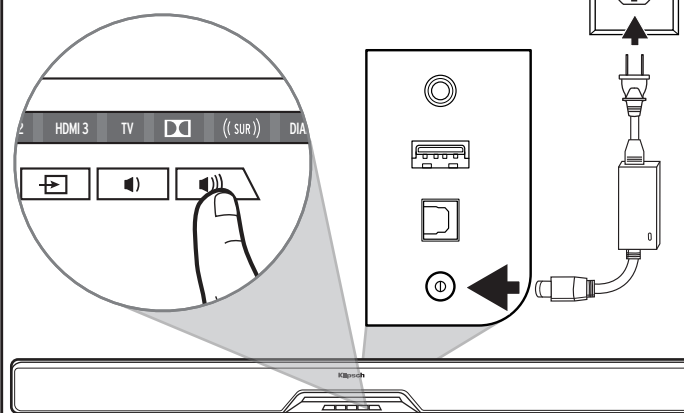

5

The Dolby Digital LED will light up when the MCU firmware update has started and you can release the Vol+ key.

6

As the update installs - the Virtual Surround Mode LED will light up, then the Dialog LED, then the Night Mode LED. All LED's will turn off when the update is complete and the unit will power down.

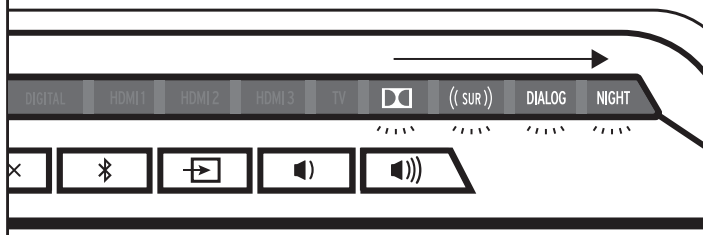

7

Press the Power button on the Soundbar Remote Control to power the unit back on.

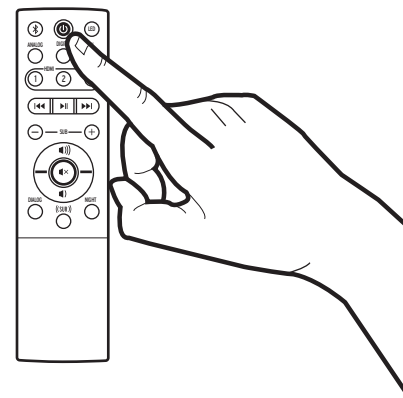

RSB-11 SOUNDBAR FIRMWARE UPDATE INSTRUCTIONS **Klipsch** REFERENCE

- 8** Wait 5 seconds, then press the Power button on the Soundbar Remote Control again to power down.
- 9** With the Soundbar off, press and hold the Mute and Source keys on the Soundbar.

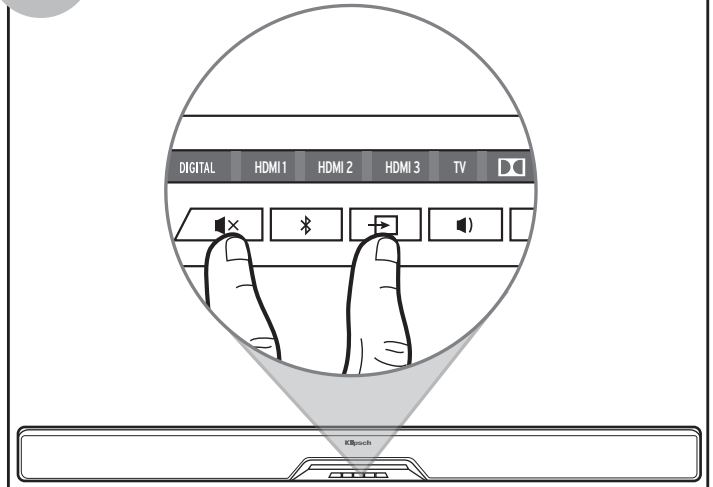
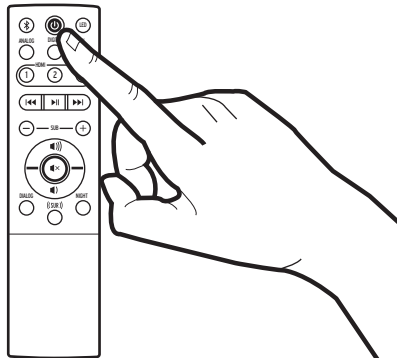

- 10** The Digital LED will light up indicating that the DSP firmware installation has begun. Release the Mute and Source keys.

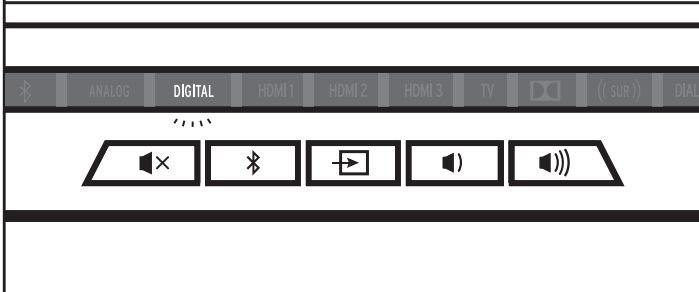

- 11** As the update installs - the HDMI1 LED will light up, then the HDMI2 LED, then the HDMI3 LED, then the TV LED. *

**The Bluetooth LED will light if the update has failed*

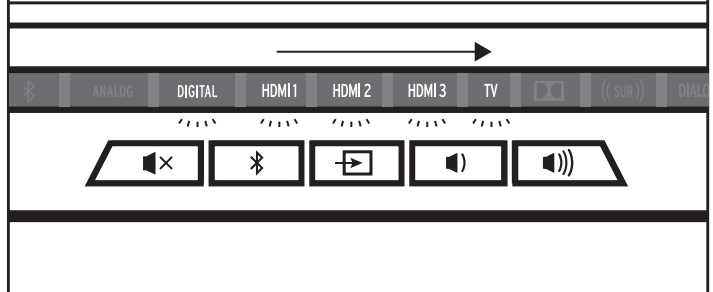

- 12** Unplug the power cord.

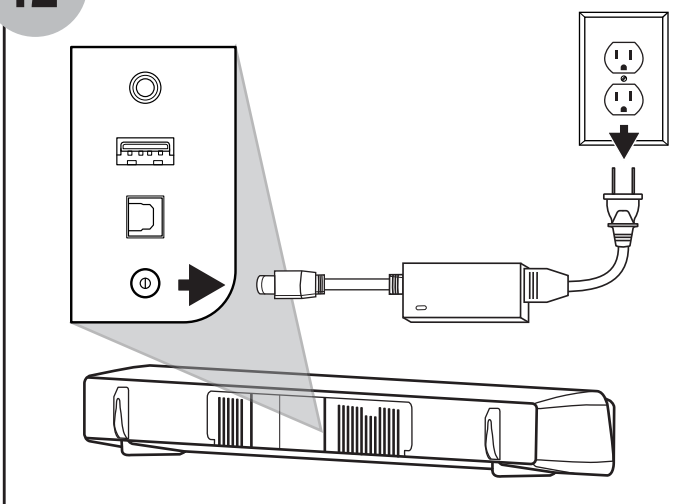

- 13** Remove the USB flash drive. Your Soundbar firmware is now up to date and your Soundbar should operate normally.

